

Submersible Contractor De-watering Pumps

Compact design, high/low head inter-changeable for handling extremely abrasive media, ranging from general construction to civil engineering.

Output:

3.7Kw & 5.5Kw.

Features:

- Construction:

- Completely water-tight cable entry sealed with epoxy resin , the individual cores are embedded in cast resin to prevent water tracking.
- Durable cast iron outer case in semi-interior construction achieves superior heat dissipation.
- Stainless steel strainer.

- Motor:

- Oil-free hermetically sealed, with built-in thermal overload protector.
- 3 phase, 2 pole, 50Hz 2850 rpm or 60Hz 3450 rpm, Insulation Class F=155°C, Protection type IP68.

- Bearing:

- The motor shaft is supported by lubricated-for-life and maintenance free ball bearings.

- Shaft sealing:

- Shaft in high quality corrosion-resistant stainless steel.
- Double mechanical seals (one TC/TC or SIC/SIC+one Carbon/Ceramic) ensure greatest durability.
- Oil chamber filled with oil ISO VG32.

- Impeller:

- The well-balanced impeller is made of High Chrome Steel with hardness 55-58 Rockwell C.
- High head/low volume and low head/high volume are inter-changeable by merely changing impeller and discharge coupling.

- Inlet Plate & Pump Casing:

- Made of wear-resistant ductile iron to withstand very abrasive liquids.

- Others:

- Max. liquid temperature: 40°C (104°F)
- Depth submerged \leq 10M
- Standard cable: 4C \times 3.5mm² \times 11.5mm (Dia.) \times 6m (Length) - Output 3.7Kw
3C \times 5.5mm² \times 11.5mm (Dia.) \times 6m (Length) - Output 5.5Kw



Applications:

- * General construction & civil engineering application.
- * Tunnel & subway construction, mining and reclamation operation.
- * Deep-well pre-dewatering.

Parts List:

No.	Description	Material
1	Hose Tail	AC
2	Cable Gland	Fiber Plastic
4	Upper Cover	FC200
6	Pump Casing	FCD450
7	Bearing Block	FC200
8	Bearing Disc	SPC
10	Inlet Plate	FCD450
11	Strainer	SUS304
12	Bottom Plate	FCD450
13	Shaft	SUS420J2
14	Rotor	Silicon Steel
16	Stator	Silicon Steel
17	Coil	
20	Handle	SUS304
21	Motor Frame	FC200
23	Key	SUS304
24	Shfat Sleeve	SUS420J2
25a-b	Bearing	Ball Bearing
26	Oil Seal	NBR
27	Motor Protector	
28a-c	O-Ring	NBR
29a-b	Gasket	NBR
30a	Mech. Seal	CE/CA
30b	Mech. Seal	SIC/SIC
31	Cable Sleeve	NBR
32	Cable	
34	Collar	SC40
39	Impeller	HCR
41	Nut	SUS304
42a-l	Screw	SUS304
43	Steel Ring	SUS304
69	Bolt	SUS304
87	Grip	SUS304
89	Spring	SC40
90	Block Cover	SPC

Performance Curves:

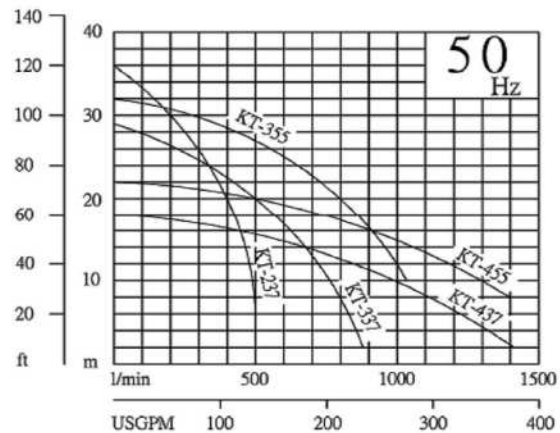
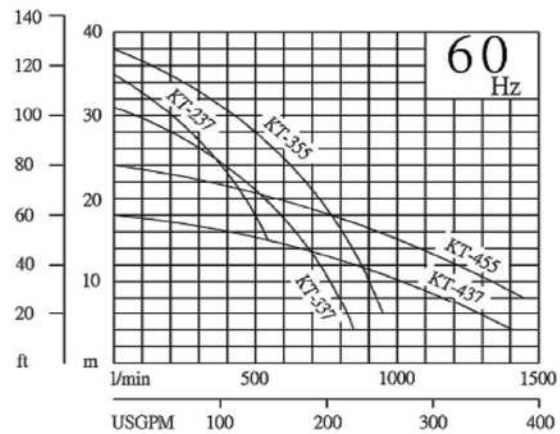

Dimensions:

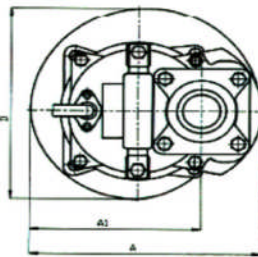
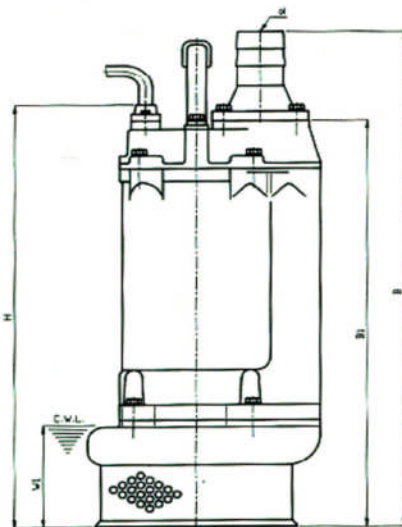

C.W.L.: Continuous Running Water Level
Unit: mm

Sectional Drawing:

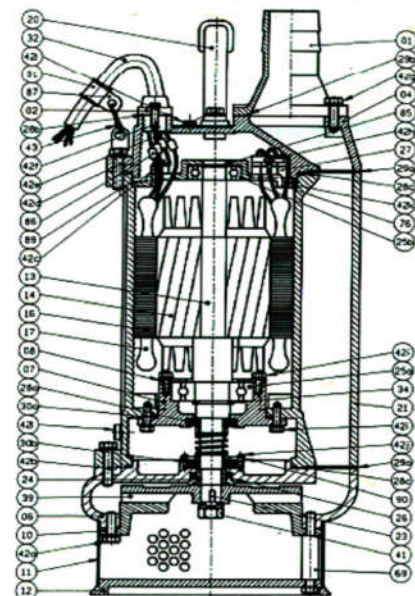

Technical Specifications:

Type	Outlet		Output		Voltage	Nor. Head		Nor. Capacity		Max. Head		Max. Capacity		Solid Passing		Weight	
	mm	inch	Kw	Hp		m	Ft.	l/min.	USGPM	m	Ft.	l/min.	USGPM	mm	inch	Kg	lb
KT-237	50	2	3.7	5	3p,220/380 415/440	30	98.4	200	53	36	118	500	132	10	10	52	115
KT-337	80	3	3.7	5		20	65.6	500	132	30	98.4	900	238	10	10	52	115
KT-437	100	4	3.7	5		10	32.8	1000	264	18	59	1500	396	15	15	52	115
KT-355	80	3	5.5	7.5		25	82	600	159	32	105	1200	317	10	10	68	150
KT-455	100	4	5.5	7.5		15	49.2	1000	264	22	72	1700	449	15	15	68	150

* All specifications are subject to change without notice.